



117 Amesbury Drive Churton Park, WLNZ



5



3



2

The Ultimate Family Home

This captivating executive home has been designed with function and style and oozes with charm from the moment you step inside. Its abundant space, extensive inventory, modern and vibrant colours will create a lasting impression, even on the most discerning buyer.

The 5 bedrooms, 3 bathrooms and multiple living rooms will appeal to families: with teenagers, toddlers, extended and blended families.

The kitchen is the heart of this home, is efficient and convenient with its durable composite benchtop and modern appliances. The extensive breakfast bar with seating for many, is a focal area for mixing conversation, liquid refreshments and culinary delights.

The home is in a highly desirable location, zoned for Amesbury school and only a short distance to the bus and to Churton Park shops.

Craig Freear

0274441922

117 Amesbury Drive
CHURTON PARK

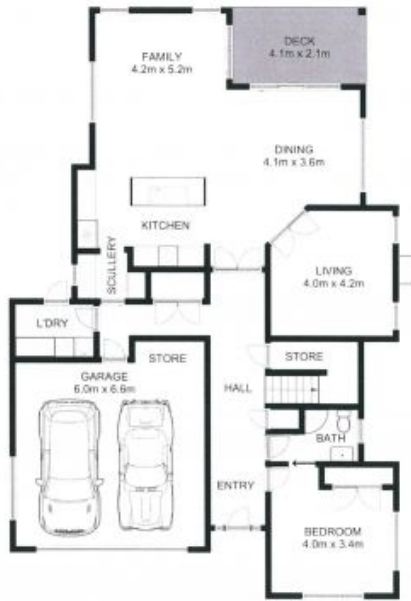

indicative only. Dimensions are approximate. All information contained herein is gathered from sources we believe to be reliable. However, we cannot guarantee its accuracy and interested persons should rely on their own enquiries.