



4 Atamira Close Churton Park, Wellington



The GOOD LIFE

awaits you when you purchase this modern & spacious 3 bedroom home set in a peaceful family neighbourhood, close to all the amenities of Churton Park.

You will love the expansive open plan living, study or 4th bedroom, semi ensuite bathroom, 2 x WC's & double garaging. The cozy double glazing & the gas heating gives you 'wall to wall' comfort during those chilly winter nights, while the sunny, private, easy care section ensures you can spend more time enjoying the things you really love to do.

Closed Tender 10 April 2019 at 1.00pm

Craig Frear

0274441922

© 2018 Craig Freear Real Estate Now. All rights reserved. This document is for informational purposes only and does not constitute an offer of real estate. Please contact your agent for more information.

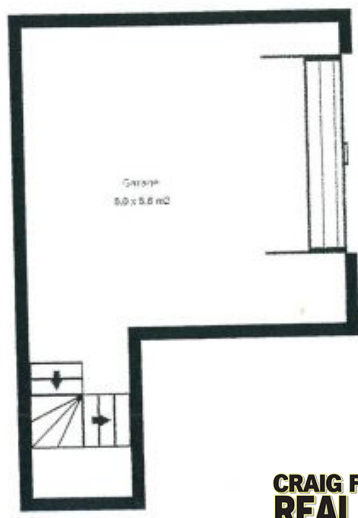

4 Atamira Close

Churton Park, Wellington

**CRAIG FREEAR
REAL ESTATE NOW**